

Архангельск (8182)63-90-72  
Астана (7172)727-132  
Астрахань (8512)99-46-04  
Барнаул (3852)73-04-60  
Белгород (4722)40-23-64  
Брянск (4832)59-03-52  
Владивосток (423)249-28-31  
Волгоград (844)278-03-48  
Вологда (8172)26-41-59  
Воронеж (473)204-51-73  
Екатеринбург (343)384-55-89  
Иваново (4932)77-34-06

Ижевск (3412)26-03-58  
Иркутск (395)279-98-46  
Казань (843)206-01-48  
Калининград (4012)72-03-81  
Калуга (4842)92-23-67  
Кемерово (3842)65-04-62  
Киров (8332)68-02-04  
Краснодар (861)203-40-90  
Красноярск (391)204-63-61  
Курск (4712)77-13-04  
Липецк (4742)52-20-81  
Киргизия (996)312-96-26-47

Магнитогорск (3519)55-03-13  
Москва (495)268-04-70  
Мурманск (8152)59-64-93  
Набережные Челны (8552)20-53-41  
Нижний Новгород (831)429-08-12  
Новокузнецк (3843)20-46-81  
Новосибирск (383)227-86-73  
Омск (3812)21-46-40  
Орел (4862)44-53-42  
Оренбург (3532)37-68-04  
Пенза (8412)22-31-16  
Россия (495)268-04-70

Пермь (342)205-81-47  
Ростов-на-Дону (863)308-18-15  
Рязань (4912)46-61-64  
Самара (846)206-03-16  
Санкт-Петербург (812)309-46-40  
Саратов (845)249-38-78  
Севастополь (8692)22-31-93  
Симферополь (3652)67-13-56  
Смоленск (4812)29-41-54  
Сочи (862)225-72-31  
Ставрополь (8652)20-65-13  
Казахстан (772)734-952-31

Сургут (3462)77-98-35  
Тверь (4822)63-31-35  
Томск (3822)98-41-53  
Тула (4872)74-02-29  
Тюмень (3452)66-21-18  
Ульяновск (8422)24-23-59  
Уфа (347)229-48-12  
Хабаровск (4212)92-98-04  
Челябинск (351)202-03-61  
Череповец (8202)49-02-64  
Ярославль (4852)69-52-93

<https://celette.nt-rt.ru> || [cfe@nt-rt.ru](mailto:cfe@nt-rt.ru)

## Дополнительное оборудование для систем натяжения зажимов

Дополните свое оборудование большим выбором систем натяжения зажимов.

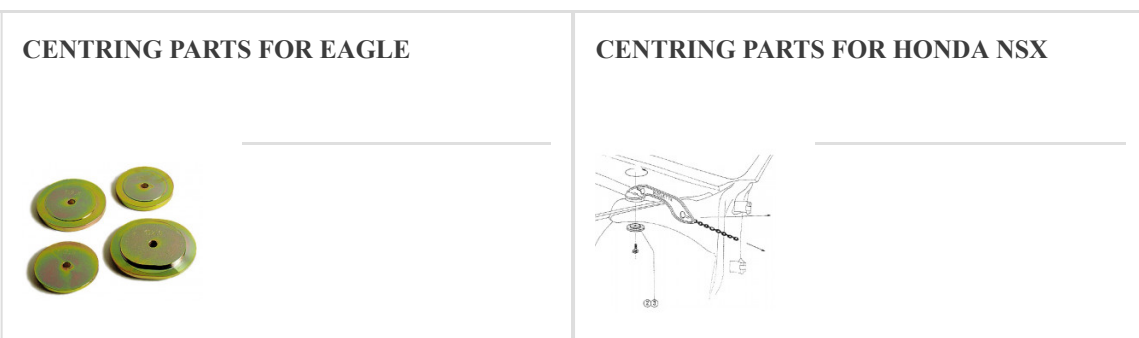

CENTRING PART PORSCHE BOXSTER

CENTRING PARTS FOR SMART

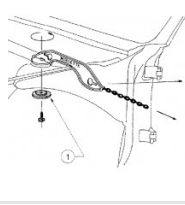
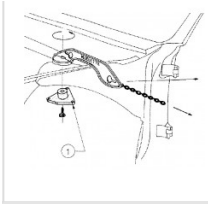

**PULLEY-BLOCK**

**PULLEY-BLOCK**



**AXLE FOR DOWNARD PULLS**

**CENTRING PART FOR SAAB**

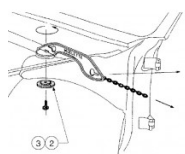

**CENTRING PARTS FOR FIAT**

**VOLVO CENTREURS POUR MC PHERSON**

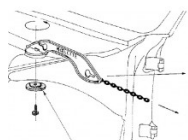

**CENTRING PARTS FOR NISSAN**

**CENTRING PARTS FOR MAZDA**

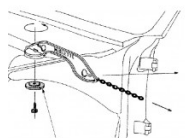

**CENTRING PARTS FOR VOLVO RANGE**

**CENTRING PARTS FOR TOYOTA**

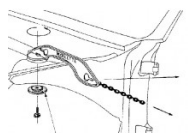

**CENTRING PARTS FOR BMW RANGE**

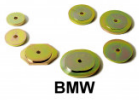

BMW

**FORD CENTREURS POUR MC PHERSON**



**FORD CENTREURS POUR MC PHERSON**



**CENTRING PARTS FOR OPEL RANGE**

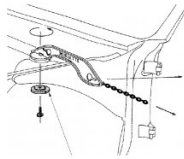

**CENTRING PARTS FOR CITROEN**

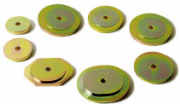

**CENTRING PARTS FOR FORD**

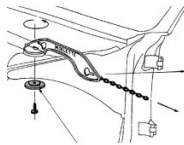

**SET OF CENTRING PARTS FOR AUDI,**



**PEUGEOT CENTREURS POUR MC.PHERSON**



**CENTRING PARTS FOR RENAULT RANGE**

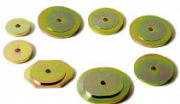

**CENTRING PARTS FOR CITROEN & PEUGEOT**

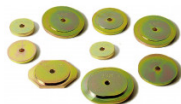

**PULL HOOK**



**PINCE AUTO-SERREUSE 50MM**



**UNIVERSAL PULL CLAMP**

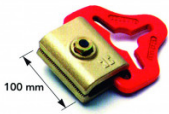

**30 MM SELF LOCKING CLAMP**

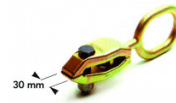

**30 MM SELF LOCKING CLAMP**



**30 MM SELF LOCKING CLAMP**



**PULLING FLANGE**



**MERCEDES BRAS DE TRACTION MC.P**

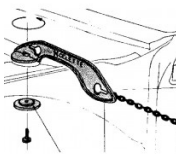

**30 MM SELF LOCKING CLAMP**



**GM BRAS DE TRACTION MC.PHERSON**



**PULLING CLAMP**

**COMPLETE PULLING ARM**

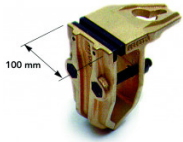

**ACCESSORY FOR VECTOR'''**

**PULLING CLAMP FOR MERCEDES**



**MULTI-FUNCTION PULLING CLAMP**

**PULL CLAMP 30 MM**

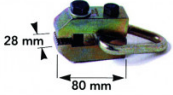

**PULL CLAMP, 32 MM WIDE**

**PULLING CLAMP**

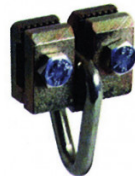

**C PULLING CLAMP**

**CLAMP TO EFFECT PULLINGS**



**ACC. MC PHERSON UNVERSEL**

**UNIVERSAL FLANGE**

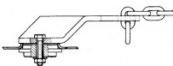

**BTR FLANGE FOR RANGE AUDI**

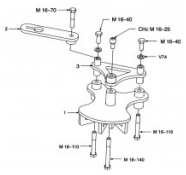

**AUDI A6 TYPE 4F**

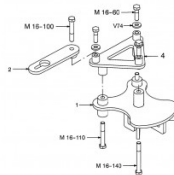

**COMPLEMENTARY SET FOR A6 TYPE 4F**

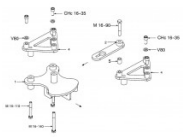

**PULLING FLANGE**

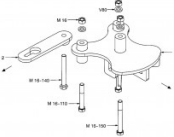

**ANCHORING + PULLING STRAP**

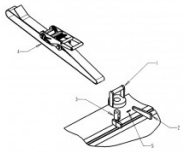

**ANCRAGE+SANGLE POUR CHASSIS AU SOL**

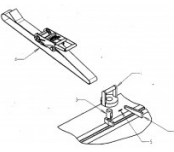

**OUTILLAGE DE TRACTION**



**SET OF 2 CLAMPS TO BE ADAPTED**



**PAIR OF SILL CLAMPS**



**HOLDING DEVICE FOR FRAMES**



**DOUBLE HOLDING DEVICE**



**PLAQUE D'ANCRAGE**



**ADAPTATION PARTS**



**SAFETY CABLE FOR CLAMPS**



**PULLING SET**



**PULLING SET**



**COMPOS DE TRACTION (EMBALLEE)**



**COMPOS DE TRACTION (EMBALLEE)**



**PULLING SET**

**COMPOS DE TRACTION (EMBALLEE)**



COMPOSITION DE TRACTION

COMPOSITION DE TRACTION



ANCHORING SET

COMPOSITION DE TRACTION



COMPOSITION DE TRACTION

COMPOSITION DE TRACTION



PULLING COMPOSITION

COMPOS HYDRAULIQUE (EMBALLEE)



COMPOSITION DE TRACTION

COMPOS DE TRACTION (EMBALLEE)





COMPOSITION DE TRACTION



COMPOSITION DE TRACTION



CHAIN 1,30 M



CHAIN 2,40 M



CHAIN 2,40 M, WITH 2 HOOKS



CHAIN 3,00 M



CHAIN 3,00 M, WITH ONE HOOK



CHAINE 3M (2 CROCHETS NOIRES)



**CONNECTING HOOK**



**DOUBLE-HOOK**



**DOUBLE HOOK**



**2 PULLING STRAPS**



**PULLING UNIT SEVENNE''''**



**PULLING UNIT SEVENNE''''**

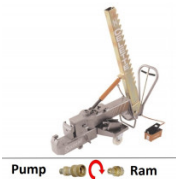

**PULLING UNIT SEVENNE Replaced by SVN19.301**



**PULLING UNIT SEVENNE Replaced by SVN19.303**



**DYNO 2000 PULLING TOWER**



**DYNO 2000 PULLING TOWER**



**SEVENNE PULLING UNIT**

**BTR FLANGE FOR RANGE AUDI A4/A5**



**ZINC SCREW HM 6X20 CL8.8**



**ZINC SCREW HM 10X50 CL8.8**



**ZINC SCREW HM 10X70 CL8.8**



**ZINC SCREW HM 12X30 CL8.8**



**VIS HM 14/150X190 CL8.8**



**ZINC SCREW HM 20X80 CL8.8**



**ZINC SCREW CHC 8X10**



**ZINC SCREW CHC 8X16**



**ZINC SCREW CHC 8X90**



**VIS TFHC 8X16 CL10.9 DIN 7991**



**OUTSIDE CIRCLIP Diam 12 mm**



**REP.06 DU 8510.013 (ZINGUAGE)**



**NUTS HM4 CL8.8**



**NUTS HM5 CL8.8**



**NUTS HM6 CL8.8**



**NUTS HM8 CL8.8**



**NUTS HM10 CL8.8**



**NUTS HM10/125**



**NUTS HM12 CL10.9**



**NUTS HM12/125**



**NUTS HM12/150**



**NUTS HM14 CL8.8 ZINGUE**



**NUTS HM14/150**



**NUTS HM16 CL10.9**



**NUTS HM18 CL8.8**



**LANDMARK 05 of 9121.523**



**NUTS HM22 CL8.8**



**YELLOW HOOK for BENCH SILL CLAMPS**



**POUTRE VECTEUR POUR "SEVENNE"**  
(replaced by pulling unit RH07.20x)

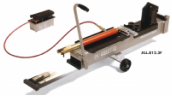

**NUTS HM24 CL8.8**



**NUTS HM24 CL10.9**



**ADAPTATION KIT for COBRA on SEVENNE**

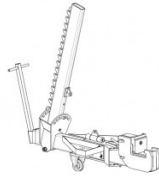

**REP.01 DU 9128.013(PEINT)**



**REP.02 DU 9128.013(PEINT)**



**CARRE DE 16 LG 812**



**OXYC.EP.10 LG 160X190 (9A109) T**



**LANDMARK 03 of Pulling Unit SEVENNE**  
**9128.013**



**REP.04 DU 9128.013( PEINT**  
**GRISRAL9007)**



**CARRE DE 70 DU 9128.704**



**REP.05 DU 9128.013(PEINT)**



**REP.08 DU 9128.013(PHOSPHAT)**



**REP.10 DU 9128.013 (PHOSP)**



**SEVENNE Pulling Unit Basket**

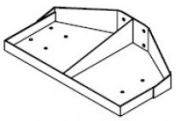

**REP.13 DU 9128.013 (9A108) EP.25 T**



**REP.14 DU 9128.013(ZINGUAGE)**



**REP.16 DU 9128.013(PEINT)**



**REP.17 DU 9128.013(PEINT)**



**REP.19 DU 9128.013**



**REP.20 DU 9128.013**



**REP.23 DU 9128.013(PEINT)**



**REP.27 DU 9128.013(ZINGUAGE)**



**REP.28 DU 9128.013(ZINGUAGE)**



**REP.29 DU 9128.013(PEINT)**



**REP.30 DU 9128.013 (PHOSPHAT)**



**CAPOT DU 9128.013(PEINT)**



**BOUTON EQUERRE (phosphate)**



**NUTS HM39 CL8.8**



**SUPPORT TREUIL MECANIQUE**



**TREUIL MANUEL**

**SECURITY NUT M10**



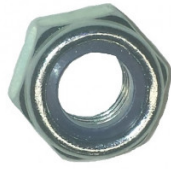

**ACCESSORIES HOLDER for PULLING UNIT with GAPS**

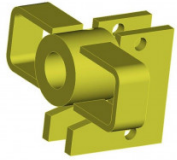

**SEVENNE STICKER 200X45 mm**



**SECURITY STICKER for PULLING UNIT 60X85**



**STICKER "CELETTE" 280 mm X 200 mm**



**STICKER "CELETTE" 290 mm X 100 mm WHITE**



**LANDMARK A1 of ATD.1343**



**WEDGE**



**WEDGE CLAMP**



**PINCE AUTOSERREUSE 75mm**



**1/2 PINCE 30MM BOUT DEGAGE (IND. B)**

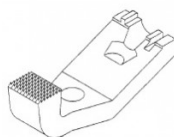

**DEMIE PINCE AUTOMATIQUE**



**CROSSE D'ANCRAGE MAC-PHERSON**



**RONDELLE**



**AXE A SERRAGE RAPIDE**



**BRIDE DE TRACTION (PEINTURE)**



**BRIDE DE TRACTION**



**MOUSQUETON POUR CABLE DE SECURITE**



**CYLINDRICAL CAP of Diam 28**



**SQUARE CAP**



**SQUARE CAP of 40**



**OIL TIN of 1 L**



**OIL TIN of 5 L**



**HYDROPNEUMATIC PUMP DISTANCE for TOUR DYNO 2000**



**HYDROPNEUMATIC PUMP DISTANCE for TOUR MENYR GEN. 2**



**JONC PLAN 954.16**



**GALET D 125 X 40 POLYPROPYLENE**



**RESSORT COMPRESSION**



**PULLING UNIT SEVENNE for BMW**



**PIN diameter 18 + WIRE**



**SEVENNE PULLING UNIT (Evolve in SVN05.151)**



**SEVENNE PULLING UNIT (Evolve in SVN05.153)**



**X-Trac Pulling Unit**



**SEVENNE Pulling Unit (Replaces SVN05.301)**



**SEVENNE Pulling Unit (Replaces SVN05.303)**



**KIT FOR FLANGE ATD.149**



**ENSEMBLE "3 POINTS" 3 POSTES DE TRAVAIL**



**NUTS HM12 CL8.8**



**LANDMARK 04 of 9121.523**



**SECURITY NUT M6**

**SECURITY NUT M12**

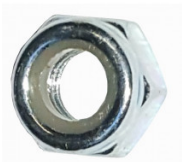

SECURITY NUT M14

SECURITY NUT M16

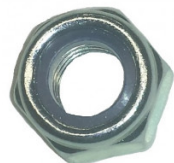

NUTS of ATD.1343

ADAPTATEUR POUR SUPPORT D'AXE



Архангельск (8182)63-90-72  
 Астана (7172)727-132  
 Астрахань (8512)99-46-04  
 Барнаул (3852)73-04-60  
 Белгород (4722)40-23-64  
 Брянск (4832)59-03-52  
 Владивосток (423)249-28-31  
 Волгоград (844)278-03-48  
 Вологда (8172)26-41-59  
 Воронеж (473)204-51-73  
 Екатеринбург (343)384-55-89  
 Иваново (4932)77-34-06

Ижевск (3412)26-03-58  
 Иркутск (395)279-98-46  
 Казань (843)206-01-48  
 Калининград (4012)72-03-81  
 Калуга (4842)92-23-67  
 Кемерово (3842)65-04-62  
 Киров (8332)68-02-04  
 Краснодар (861)203-40-90  
 Красноярск (391)204-63-61  
 Курск (4712)77-13-04  
 Липецк (4742)52-20-81

Киргизия (996)312-96-26-47

Магнитогорск (3519)55-03-13  
 Москва (495)268-04-70  
 Мурманск (8152)59-64-93  
 Набережные Челны (8552)20-53-41  
 Нижний Новгород (831)429-08-12  
 Новокузнецк (3843)20-46-81  
 Новосибирск (383)227-86-73  
 Омск (3812)21-46-40  
 Орел (4862)44-53-42  
 Оренбург (3532)37-68-04  
 Пенза (8412)22-31-16

Россия (495)268-04-70

Пермь (342)205-81-47  
 Ростов-на-Дону (863)308-18-15  
 Рязань (4912)46-61-64  
 Самара (846)206-03-16  
 Санкт-Петербург (812)309-46-40  
 Саратов (845)249-38-78  
 Севастополь (8692)22-31-93  
 Симферополь (3652)67-13-56  
 Смоленск (4812)29-41-54  
 Сочи (862)225-72-31  
 Ставрополь (8652)20-65-13

Казахстан (772)734-952-31

Сургут (3462)77-98-35  
 Тверь (4822)63-31-35  
 Томск (3822)98-41-53  
 Тула (4872)74-02-29  
 Тюмень (3452)66-21-18  
 Ульяновск (8422)24-23-59  
 Уфа (347)229-48-12  
 Хабаровск (4212)92-98-04  
 Челябинск (351)202-03-61  
 Череповец (8202)49-02-64  
 Ярославль (4852)69-52-93